



IP68

SP Series

- SP系列 IP68
- SP Series IP68
- 螺纹锁紧
- Threaded coupling



★ 接触件可以是插针或插孔
Each side can be male or female contact

材料和技术参数 Material and spec

接插方式	Coupling	螺纹锁紧	Threaded
外壳材料	Shell material	热塑性塑料PC, PA66 防火等级: V-0	PC, Nylon66, fire resistance: V-0
绝缘体	Insert material	热塑性塑料PPS, 耐高温260℃	PPS, max temperature 260 °C
接触件材料	Contact material	铜镀金	Brass with gold plating
接线方式	Termination	焊接: SP 11, SP13, SP17, SP21, SP25, SP29 压接: SP17, SP21, SP25, SP29 螺丝压接: SP21, SP25, SP29(∅2.5, ∅3, ∅3.5mm插针)	Solder: SP 11, SP13, SP17, SP21, SP25, SP29, Crimp: SP17, SP21, SP25, SP29 Screw: SP21, SP25, SP29(∅2.5, ∅3, ∅3.5mm contact)
电缆直径	Cable outer diameter range	SP11: I: 3-4mm, II: 4-6.5mm(不标) SP17: 6-10mm SP25: I: 10-14mm (不标), II: 7-12mm	SP13: I: 4-6.5mm(不标), II: 5-8mm SP21: I: 4.5-7mm, II: 7-12mm(不标), III: 5-9mm SP29: I: 9-13mm, II: 13-16mm(不标)
防护等级	IP rating	IP68	
接插次数	Mating cycle	500	
温度范围	Temperature range	-40℃~+85℃	
绝缘电阻	Insulation resistance	2000 MΩ	

SP
11

SP11 Series



电缆插头
与SP1111、SP1111C、
SP1112相配

Cable connector
Mate with SP1111,
SP1111C, SP1112

SP1110/P

SP1110/S

插针 Male contact

电缆直径: Cable outer diameter range
I: 3-4mm II: 4-6.5mm(不标)

芯数 Number of contact

插孔 Female contact

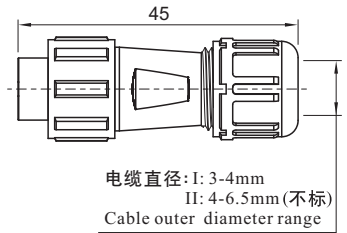
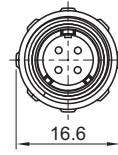

电缆直径: I: 3-4mm
II: 4-6.5mm(不标)
Cable outer diameter range



电缆对接插座 C
与SP1110相配

In-line cable connector C
Mate with SP1110

SP1111C/P

SP1111C/S

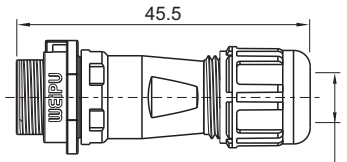
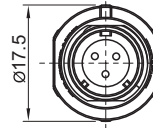

电缆直径: I: 3-4mm
II: 4-6.5mm(不标)
Cable outer diameter range



后螺母插座
与SP1110相配

Rear-nut mount
Mate with SP1110

SP1112/P

SP1112/S

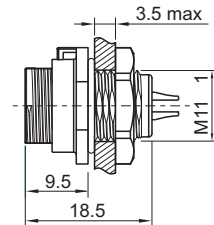
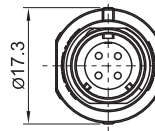

开孔尺寸
Panel cutout



焊接芯件参数
Solder contact spec

芯数 Number of contact	2	3	4	5
公端绝缘体正面图 Male contact face view				
额定电流 (A) Rated current (A)	5	5	3	3
接触件直径(mm) Contact diameter(mm)	Ø1×2	Ø1×3	Ø0.7×4	Ø0.7×5
工作电压 (AC.V) Rated voltage (AC.V)	180	180	125	125
耐压 (AC.V) 1 min Test voltage(AC.V) 1 min	1000	1000	1000	1000
接触电阻 (mΩ) Contact resistance (mΩ)	5	5	10	10
线规 (mm²/AWG) Wire size (mm²/AWG)	≤0.75/18	≤0.75/18	≤0.5/20	≤0.5/20

SP
13

SP13 Series



电缆插头
与SP1311、SP1311C、SP1312 相配

Cable connector
Mate with SP1311,
SP1311C, SP1312

SP1310 / P ——— SP1310 / S ———
插针 Male contact

电缆外径 Cable outer diameter range
I: 4-6.5mm(不标), II: 5-8mm
芯数 Number of contact
插孔 Female contact

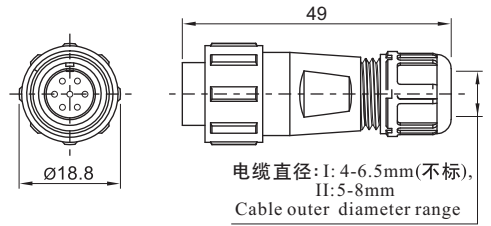

电缆直径: I: 4-6.5mm(不标),
II: 5-8mm
Cable outer diameter range



电缆对接插座 C
与SP1310 相配

In-line cable connector C
Mate with SP1310

SP1311C / P ——— SP1311 C / S ———

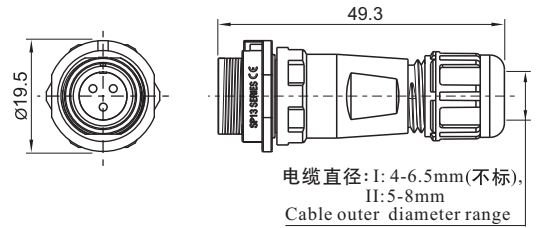

电缆直径: I: 4-6.5mm(不标),
II: 5-8mm
Cable outer diameter range



后螺母插座
与SP1310 相配

Rear-nut mount
Mate with SP1310

SP1312 / P ——— SP1312 / S ———
芯数 Number of contact

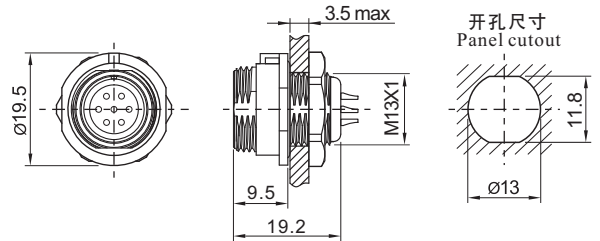

前螺母插座
与SP1310 相配

Front-nut mount
Mate with SP1310

SP1315 / P ——— SP1315 / S ———

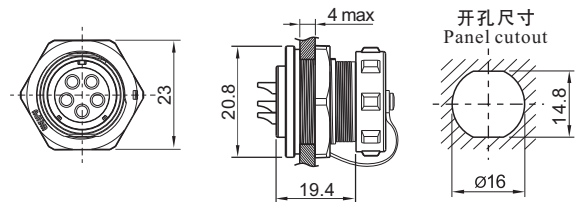

焊接芯件参数表

Solder contact spec

芯数 Number of contact	2	3	4	5	6	7	9
公端绝缘体正面图 Male contact face view							
额定电流 (A) Rated current (A)	13	13	5	5	5	5	3
接触件直径 (mm) Contact diameter (mm)	Ø1.6X2	Ø1.6X3	Ø1X4	Ø1X5	Ø1X6	Ø1X7	Ø0.7X9
工作电压 (AC.V) Rated voltage (AC.V)	250	250	200	180	125	125	125
耐压 (AC.V) 1 min Test voltage(AC.V) 1 min	1500	1500	1500	1000	1000	1000	1000
接触电阻(mΩ) Contact resistance (mΩ)	2.5	2.5	5	5	5	5	10
线规 (mm ² /AWG) Wire size (mm ² /AWG)	≤2/14	≤2/14	≤0.75/18	≤0.75/18	≤0.75/18	≤0.75/18	≤0.5/20

SP
13

SP13 Series



电缆插头
与SP1311、SP1312 相配

Cable connector
Mate with SP1311, SP1312

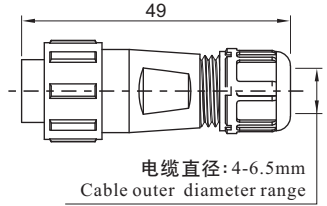
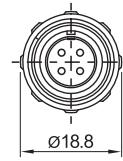

SP1310 / P

SP1310 / S

插针 Male contact

(CU): 颜色: 全黑色 Colour: All black

芯数 Number of contact

插孔 Female contact



电缆对接插座
与SP1310 相配

In-line cable connector
Mate with SP1310

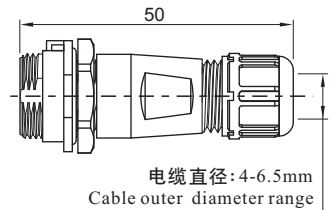
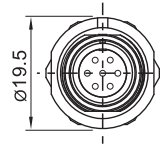

SP1311 / P

SP1311 / S



后螺母插座
与SP1310 相配

Rear-nut mount
Mate with SP1310

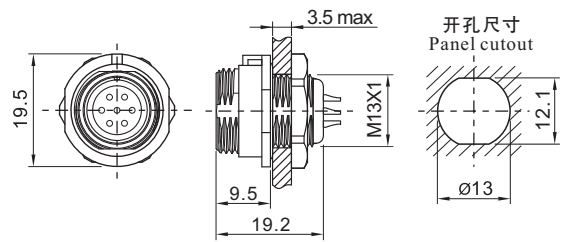

SP1312 / P

SP1312 / S

(CU):

芯数 Number of contact

焊接芯件参数表

Solder contact spec

芯数 Number of contact	4	5	6	7	9
公端绝缘体正面图 Male contact face view					
额定电流 (A) Rated current (A)	5	5	5	5	3
接触件直径 (mm) Contact diameter (mm)	Ø1X4	Ø1X5	Ø1X6	Ø1X7	Ø0.7X9
工作电压 (AC.V) Rated voltage (AC.V)	300	300	300	300	125
耐压 (AC.V) 1 min Test voltage (AC.V) 1 min	1500	1000	1000	1000	1000
接触电阻 (mΩ) Contact resistance (mΩ)	5	5	5	5	10
线规 (AWG) Wire size (AWG)	20	20	20	20	20

SP
17

SP17 Series



SP1710 / P__— SP1710 / S__—
插针 Male contact

电缆插头
与SP1711、SP1711C、SP1712相配

Cable connector
Mate with SP1711, SP1711C,
SP1712

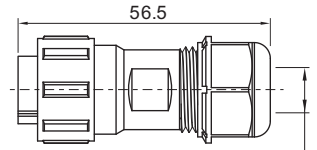
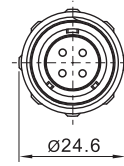

电缆直径: 6-10mm
Cable outer diameter range

1: 焊接(不标), 3: 压接
1: solder, 3: crimp
芯数 Number of contact
插孔 Female contact



SP1711C / P__— SP1711C / S__—

电缆对接插座 C
与SP1710相配

In-line cable connector C
Mate with SP1710

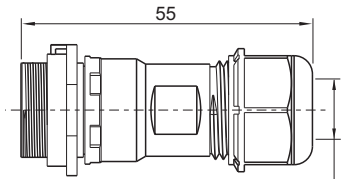
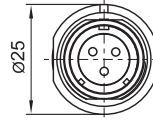

电缆直径: 6-10mm
Cable outer diameter range



SP1712 / P__— SP1712 / S__—

后螺母插座
与SP1710相配

Rear-nut mount
Mate with SP1710

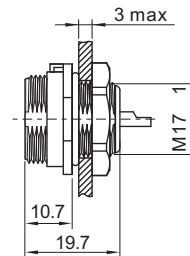
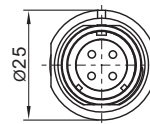

开孔尺寸
Panel cutout

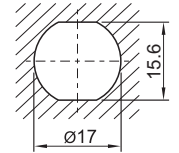

焊接芯件参数表
Solder contact spec

★压接芯件参数表在P20页>>
Crimp contact spec see P20

芯数 Number of contact	2	3	4	2B	3B	4B	5	7	9	10
公端绝缘体正面图 Male contact face view										
额定电流 (A) Rated current (A)	10	10	5	15	15	15	5	5	5	5
接触件直径(mm) Contact diameter(mm)	Ø1.5X2	Ø1.5X3	Ø1X4	Ø2X2	Ø2X3	Ø2X4	Ø1X5	Ø1X7	Ø1X9	Ø1X10
工作电压 (AC.V) Rated voltage (AC.V)	500	500	500	500	500	500	500	400	400	400
耐压 (AC.V) 1 min Test voltage(AC.V) 1 min	1500	1500	1500	1500	1500	1500	1500	1200	1200	1200
接触电阻 (mΩ) Contact resistance (mΩ)	2.5	2.5	5	2.5	2.5	2.5	5	5	5	5
线规 (mm²/AWG) Wire size (mm²/AWG)	≤2/14	≤2/14	≤0.75/18	≤2/14	≤2/14	≤2/14	≤0.75/18	≤0.75/18	≤0.75/18	≤0.75/18



SP
17

SP17 Series



侧向螺丝压接电缆插头
与SP1711、SP1712相配

Plug with horizontal mount screw
Mate with SP1711, SP1712

SP1710 / P__-9

SP1710 / S__-9

插针 Male contact

芯数 Number of contact
插孔 Female contact

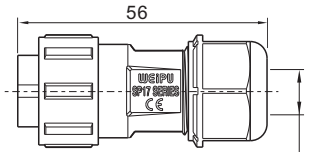
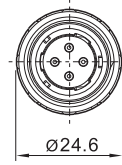

电缆直径: 6-10mm
Cable outer diameter range

05



侧向螺丝压接电缆对接插座
与SP1710相配

Connector with horizontal mount screw
Mate with SP1710

SP1711 / P__-9

SP1711 / S__-9

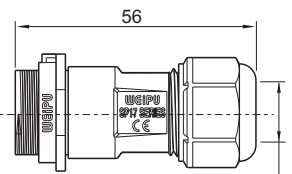
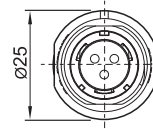

电缆直径: 6-10mm
Cable outer diameter range



侧向螺丝压接后螺母插座
与SP1710相配

Rear-nut mount receptacle with horizontal mount screw
Mate with SP1710

SP1712 / P__-9

SP1712 / S__-9

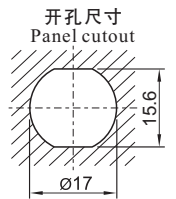
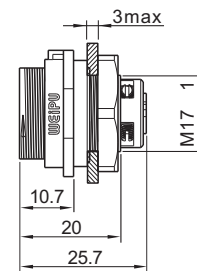
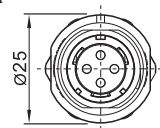

螺丝压接芯件参数表

Screw contact spec

芯数 Number of contact	2B	3B	4B
公端绝缘体正面图 Male contact face view			
额定电流 (A) Rated current (A)	15	15	15
接触件直径(mm) Contact diameter(mm)	Ø2X2	Ø2X3	Ø2X4
工作电压 (AC.V) Rated voltage (AC.V)	500	500	500
耐压 (AC.V) 1 min Test voltage(AC.V) 1 min	1500	1500	1500
接触电阻 (mΩ) Contact resistance (mΩ)	2.5	2.5	2.5
线规 (mm ² /AWG) Wire size (mm ² /AWG)	Min:0.75/18 ≤ Max: ≤2/14	Min:0.75/18 ≤ Max: ≤2/14	Min:0.75/18 ≤ Max: ≤2/14

SP21 Series

**SP
21**



SP2110 / P 插针 Male contact
SP2110 / S 插孔 Female contact

电缆插头
与SP2111、SP2111C、SP2112、SP2113相配
Cable connector
Mate with SP2111, SP2111C, SP2112, SP2113

1: 焊接 (不标), 2: 螺丝压接, 3: 压接
1: solder, 2: screw, 3: crimp
电缆直径 Cable outer diameter range
I: 4.5-7mm, II: 7-12mm (不标), III: 5-9mm
芯数 Number of contact

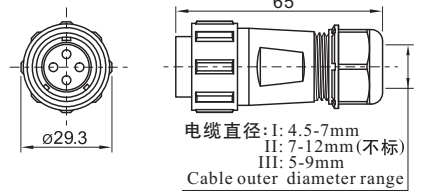

SP2116 / P 芯数 Number of contact
SP2116 / S 芯数 Number of contact

弯式电缆插头
与SP2111、SP2111C、SP2112、SP2113相配
Angled cable connector
Mate with SP2111, SP2111C, SP2112, SP2113

1: 焊接 (不标), 2: 螺丝压接, 3: 压接
1: solder, 2: screw, 3: crimp
电缆直径 Cable outer diameter range
I: 4.5-7mm, II: 7-12mm (不标), III: 5-9mm

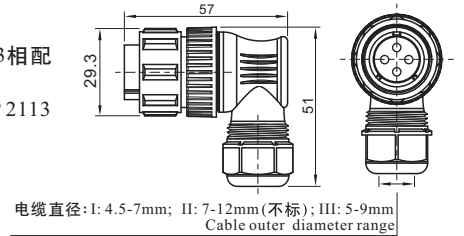

SP2111C / P 芯数 Number of contact
SP2111C / S 芯数 Number of contact

电缆对接插座C
与SP2110、SP2116相配
In-line cable connector C
Mate with SP2110, SP2116

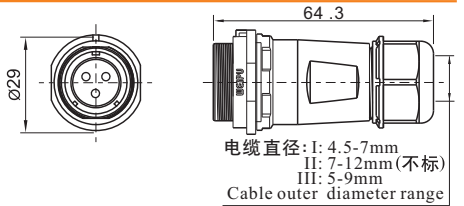

SP2112 / P 芯数 Number of contact
SP2112 / S 芯数 Number of contact

后螺母插座
与SP2110、SP2116相配
Rear-nut mount
Mate with SP2110, SP2116

1: 焊接 (不标), 2: 螺丝压接, 3: 压接
1: solder, 2: screw, 3: crimp

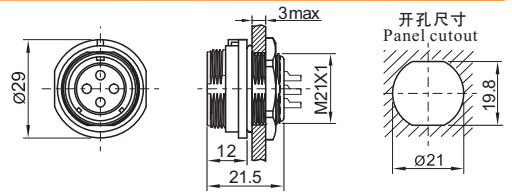

SP2113 / P 芯数 Number of contact
SP2113 / S 芯数 Number of contact

两孔法兰插座
与SP2110、SP2116相配
2-hole flange
Mate with SP2110, SP2116

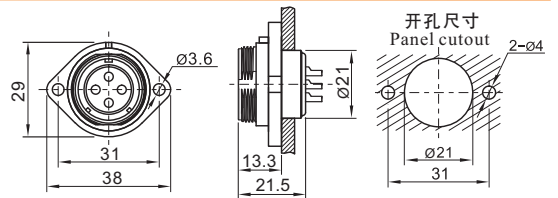

SP2115 / P 芯数 Number of contact
SP2115 / S 芯数 Number of contact

前螺母插座
与SP2110、SP2116相配
Front-nut mount
Mate with SP2110, SP2116

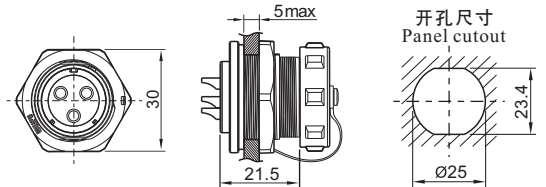

焊接芯件参数表 Solder contact spec

★压接芯件参数表在P20页>> ★螺丝压接芯件参数表在P21页>>
Crimp contact spec see P20 Screw contact spec see P21

芯数 Number of contact	2	3	4	5	5B	5C	6	6B	7	8	9	12	15
公端绝缘体正面图 Male contact face view													
额定电流 (A) Rated current (A)	30	30	30	30	30 5	15	25 5	30 5	15	10	5	5	5
接触件直径 (mm) Contact diameter (mm)	ø3X2	ø3X3	ø3X4	ø3X5	ø3X2 ø1X3	ø2X5	ø2.5X4 ø1X2	ø3X2 ø1X4	ø2X7	ø1.5X8	ø1X9	ø1X12	ø1X15
工作电压 (AC.V) Rated voltage (AC.V)	500	500	500	500	500	500	500	500	500	500	400	400	400
耐压 (AC.V) 1 min Test voltage (AC.V) 1 min	1500	1500	1500	1500	1500	1500	1500	1500	1500	1500	1200	1200	1200
接触电阻 (mΩ) Contact resistance (mΩ)	1	1	1	1	1 5	2.5	1 5	1 5	2.5	2.5	5	5	5
接线方式 Termination	焊接/螺丝压接 solder/screw	焊接/螺丝压接 solder/screw	焊接/螺丝压接 solder/screw	焊接/螺丝压接 solder/screw	焊接 solder	焊接/螺丝压接 solder/screw	焊接 solder	焊接 solder	焊接/螺丝压接 solder/screw	焊接 solder	焊接 solder	焊接 solder	焊接 solder
焊接线规 (mm ² /AWG) Wire size for solder (mm ² /AWG)	≤4/12	≤4/12	≤4/12	≤4/12	≤4/12 ≤0.75/18	≤2/14	≤4/12 ≤0.75/18	≤4/12 ≤0.75/18	≤2/14	≤2/14	≤0.75/18	≤0.75/18	≤0.75/18
螺丝压接线规 (mm ² /AWG) Wire size for screw termination (mm ² /AWG)	≤1.5/15	≤1.5/15	≤1.5/15	≤1.5/15	/	/	/	/	/	/	/	/	/



SP
21

SP21 Series



侧向螺丝压接电缆插头
与SP2111、SP2112相配

Plug with horizontal mount screw
Mate with SP2111, SP2112

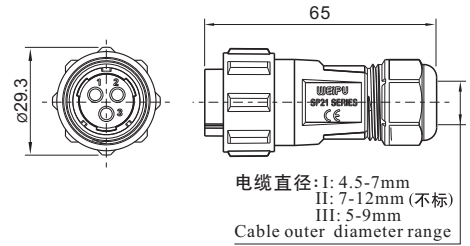

SP2110 / P__-9 SP2110 / S__-9
插针 Male contact 插孔 Female contact
电缆直径 Cable outer diameter range
I: 4.5-7mm, II: 7-12mm (不标) III: 5-9mm
芯数 Number of contact

05



侧向螺丝压接电缆对接插座
与SP2110相配

Connector with horizontal mount screw
Mate with SP2110

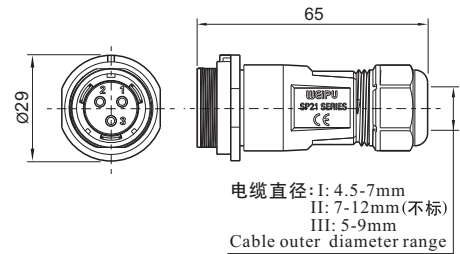

SP2111 / P__-9 SP2111 / S__-9



侧向螺丝压接后螺母插座
与SP2110相配

Rear-nut mount receptacle with
horizontal mount screw
Mate with SP2110

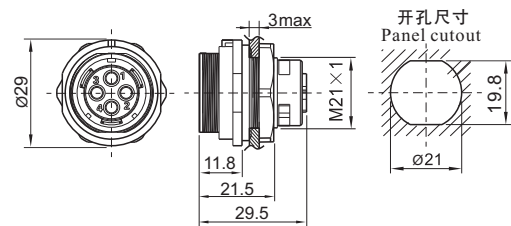

SP2112 / P__-9 SP2112 / S__-9
芯数 Number of contact



螺丝压接芯件参数表

Solder contact spec

芯数 Number of contact	2	3	4	5
公端绝缘体正面图 Male contact face view				
额定电流 (A) Rated current (A)	30	30	30	30
接触件直径 (mm) Contact diameter (mm)	ø3X2	ø3X3	ø3X4	ø3X5
工作电压 (AC.V) Rated voltage (AC.V)	500	500	500	500
耐压 (AC.V) 1 min Test voltage (AC.V) 1 min	1500	1500	1500	1500
接触电阻 (mΩ) Contact resistance (mΩ)	1	1	1	1
螺丝压接线规 (mm ² /AWG) Wire size for screw termination (mm ² /AWG)	0.75/18 ≤ Min Max ≤ 4/12	0.75/18 ≤ Min Max ≤ 4/12	0.75/18 ≤ Min Max ≤ 4/12	0.75/18 ≤ Min Max ≤ 4/12

SP21 Series



电缆插头
与SP2111、SP2112、SP2113相配

Cable connector
Mate with SP2111, SP2112, SP2113

(U): , (CU):
颜色: 全黑色 Colour: All black

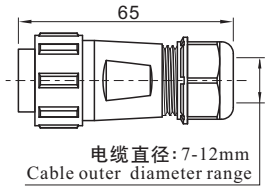
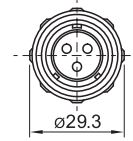

SP2110 / P __ __ SP2110 / S __ __
插针 Male contact 插孔 Female contact

芯数 Number of contact



电缆对接插座
与SP2110相配

In-line cable connector
Mate with SP2110

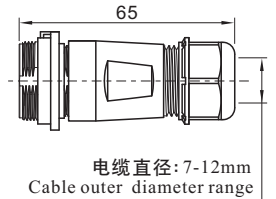
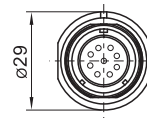

SP2111 / P __ __ SP2111 / S __ __



后螺母插座
与SP2110相配

Rear-nut mount
Mate with SP2110

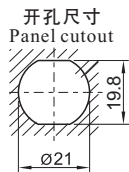
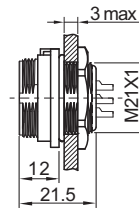
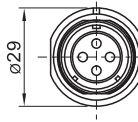

SP2112 / P __ __ SP2112 / S __ __

(U): , (CU):
芯数 Number of contact



两孔法兰插座
与SP2110相配

2-hole flange
Mate with SP2110

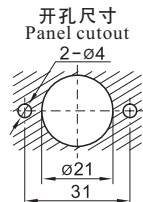
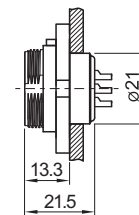
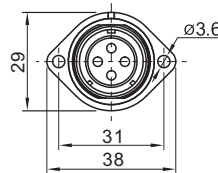

SP2113 / P __ __ SP2113 / S __ __

焊接芯件参数表

Solder contact spec

芯数 Number of contact	2	3	4	5
公端绝缘体正面图 Male contact face view				
额定电流 (A) Rated current (A)	30 20 	30 20 	30 20 	30 20
接触件直径 (mm) Contact diameter (mm)	Ø3X2	Ø3X3	Ø3X4	Ø3X5
工作电压 (AC.V) Rated voltage (AC.V)	500	500	500	500
耐压 (AC.V) 1 min Test voltage (AC.V) 1 min	1500	1500	1500	1500
接触电阻 (mΩ) Contact resistance (mΩ)	1	1	1	1
接线方式 Termination	焊接 solder	焊接 solder	焊接 solder	焊接 solder
焊接线规 (AWG) Wire size for solder (AWG)	12	12	12	12

SP25 Series



SP2510 / P --- SP2510 / S
插针 Male contact

电缆插头
与SP2511、SP2511C、SP2512、SP2513相配
Cable connector
Mate with SP2511, SP2511C, SP2512, SP2513

1:焊接(不标), 2:螺丝压接, 3:压接
1:solder, 2:screw, 3:crimp
电缆直径:Cable outer diameter range
I: 10-14mm(不标); II: 7-12mm
芯数 Number of contact
插孔 Female contact

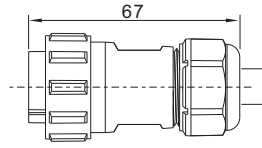
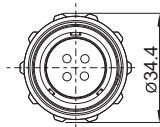

电缆直径: I: 10-14mm(不标); II: 7-12mm
Cable outer diameter range



SP2511C / P --- SP2511C / S

电缆对接插座C
与SP2510相配
In-line cable connector C
Mate with SP2510

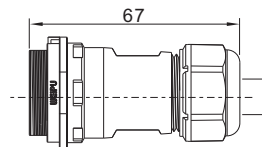
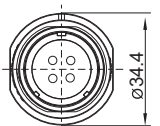

电缆直径: I: 10-14mm(不标); II: 7-12mm
Cable outer diameter range



SP2512 / P --- SP2512 / S

后螺母插座
与SP2510相配
Rear-nut mount
Mate with SP2510

1:焊接(不标), 2:螺丝压接, 3:压接
1:solder, 2:screw, 3:crimp
芯数 Number of contact

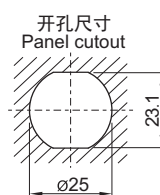
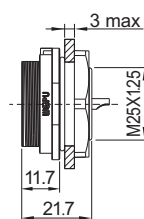
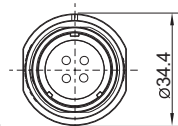

SP2513 / P --- SP2513 / S

两孔法兰插座
与SP2510相配
2-hole flange
Mate with SP2510

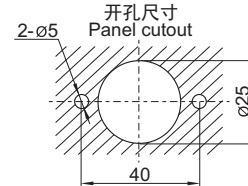
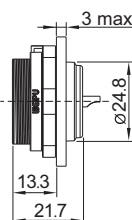
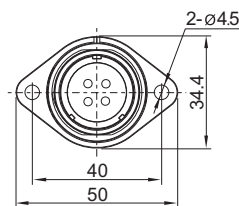

SP2515 / P --- SP2515 / S

前螺母插座
与SP2510相配
Front-nut mount
Mate with SP2510

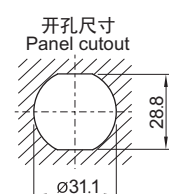
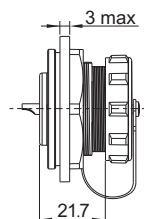
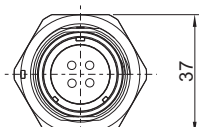

焊接芯件参数
Solder contact spec

★压接芯件参数表在P20页>>
Crimp contact spec see P20

★螺丝压接芯件参数表在P21页>>
Screw contact spec see P21

芯数 Number of contact	2	3	4	9	10	12	12B	19
公端绝缘体正面图 Male contact face view								
额定电流(A) Rated current(A)	25	25	25	5 25	10	10	5 30	5
接触件直径(mm) Contact diameter(mm)	ø2.5X2	ø2.5X3	ø2.5X4	ø1X5 ø2.5X4	ø1.5X10	ø1.5X12	ø1X9 ø3X3	ø1X19
工作电压(AC.V) Rated voltage(AC.V)	500	500	500	500	500	500	500	400
耐压(AC.V) 1 min Test voltage(AC.V) 1 min	1500	1500	1500	1500	1500	1500	1500	1200
接触电阻(mΩ) Contact resistance(mΩ)	1	1	1	5 1	2.5	2.5	5 1	5
绝缘电阻(MΩ) Insulation resistance(MΩ)	2000	2000	2000	2000	2000	2000	2000	2000
线规(mm²/AWG) Wire size(mm²/AWG)	≤4/11	≤4/11	≤4/11	≤0.75/18 ≤4/11	≤2/14	≤2/14	≤0.75/18 ≤4/11	≤0.75/18

SP29 Series



电缆插头
与SP2911、SP2911C、SP2912、SP2913相配

Cable connector
Mate with SP2911, SP2911C, SP2912, SP2913

SP2910 / P --- SP2910 / S
插针 Male contact

1:焊接(不标), 2:螺丝压接, 3:压接
1:solder, 2:screw, 3:crimp

电缆直径:Cable outer diameter range
I: 9-13mm II: 13-16mm(不标)

芯数 Number of contact
插孔 Female contact

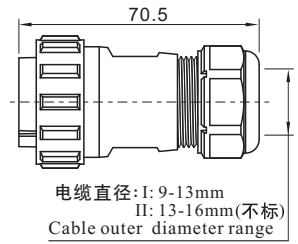
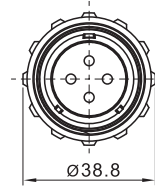

电缆对接插座C
与SP2910相配

In-line cable connector C
Mate with SP2910

SP2911C / P --- SP2911C / S ---

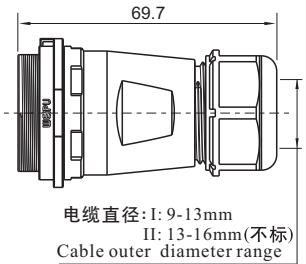
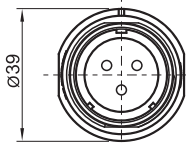

后螺母插座
与SP2910相配

Rear-nut mount
Mate with SP2910

SP2912 / P --- SP2912 / S ---

1:焊接(不标), 2:螺丝压接, 3:压接
1:solder, 2:screw, 3:crimp

芯数 Number of contact

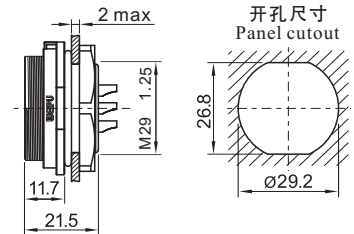
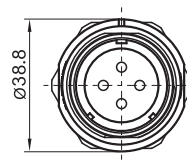

两孔法兰插座
与SP2910相配

2-hole flange
Mate with SP2910

SP2913 / P --- SP2913 / S ---

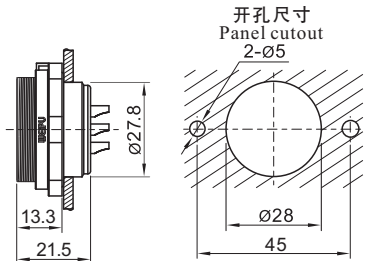
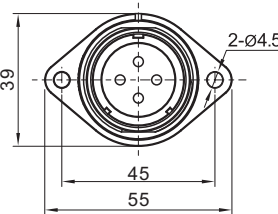

焊接芯件参数
Solder contact spec

★压接芯件参数表在P20页>>
Crimp contact spec see P20

★螺丝压接芯件参数表在P21页>>
Screw contact spec see P21

芯数 Number of contact	2	3	4	7	8	8B	9	10	10B	12	16	17	20	24	26	35	
公端绝缘体正面图 Male contact face view																	
额定电流(A) Rated current(A)	50	50	25	25	25	60, 5	25, 5	25	10	10	10	10	5	5	5	5	
接触件直径(mm) Contact diameter(mm)	Ø3.5X2	Ø3.5X3	Ø2.5X4	Ø2.5X7	Ø2.5X8	Ø5X2 Ø1X6	Ø2.5X4 Ø1X5	Ø2.5X10	Ø1.5X10	Ø1.5X12	Ø1.5X16	Ø1.5X17	Ø1X20	Ø1X24	Ø1X26	Ø1X35	
工作电压(AC.V) Rated voltage(AC.V)	500	500	500	500	500	500 400	500	500	500	500	500	500	400	400	400	400	
耐压(AC.V) 1 min Test voltage(AC.V) 1 min	1500	1500	1500	1500	1500	1500	1500	1500	1500	1500	1500	1500	1200	1200	1200	1200	
接触电阻(mΩ) Contact resistance(mΩ)	0.5	0.5	1	1	1	0.5, 5	1, 5	1	2.5	2.5	2.5	2.5	5	5	5	5	
接线方式 Termination	焊接/螺丝压接 solder/screw	焊接/螺丝压接 solder/screw	焊接/螺丝压接 solder/screw	焊接/螺丝压接 solder/screw	焊接/螺丝压接 solder/screw	焊接 solder	焊接 solder	焊接/螺丝压接 solder/screw	焊接 solder	焊接 solder	焊接 solder	焊接 solder	焊接 solder	焊接 solder	焊接 solder	焊接 solder	焊接 solder
线规(mm²/AWG) Wire size(mm²/AWG)	≤10/7	≤10/7	≤4/11	≤4/11	≤4/11	≤16/5 ≤0.75/B	≤4/11 ≤0.75/B	≤4/11	≤2/14	≤2/14	≤2/14	≤2/14	≤0.75/18	≤0.75/18	≤0.75/18	≤0.75/18	
螺丝压接线规(mm²/AWG) Wire size for screw termination	≤6/10	≤6/10	≤1.515	≤1.515	≤1.515	/	/	≤1.515	/	/	/	/	/	/	/	/	